

**lambert&fils**

Sainte Collection

April 2026

A dance of contrasting materials and an equilibrium of opposing forces.

Sainte is a collaboration Canadian designer Rachel Bussin.



# Introducing Sainte

First unveiled at the Caffè Populaire exhibition during Milan Design Week 2019, Sainte announced itself as a colorful statement.

Sculptural in scale, the original pieces were conceived for large spaces and high ceilings: bold, hued transparent panels with a pronounced presence and weight. Grand lighting designed to create a spectacle





## Rachel Bussin, the designer

Rachel Bussin is a Canadian designer based in Montréal. Formerly Lead at Lambert & Fils, where she created the Sainte lighting collection, she later co-founded Studio Kiff, a bold commercial interiors practice. Today she runs her own studio, exploring objects, lighting, and spatial design with a sculptural and innovative approach.

## Sainte's ethos.

Sainte is a collection about the forces that anchor us, a suspension light in dialogue with gravity. Streamlined yet impactful, it reimagines the archetypal rectangle in colourful acrylic panels, an elegant transparent mass floating in space and supported by robust nylon ribbon.

At its core, two mass-tinted acrylic side panels, each color running through the material in its entirety. Rather than reflecting light, Sainte absorbs it, releasing it back in a diffusion that is soft, homogeneous, and uninterrupted.

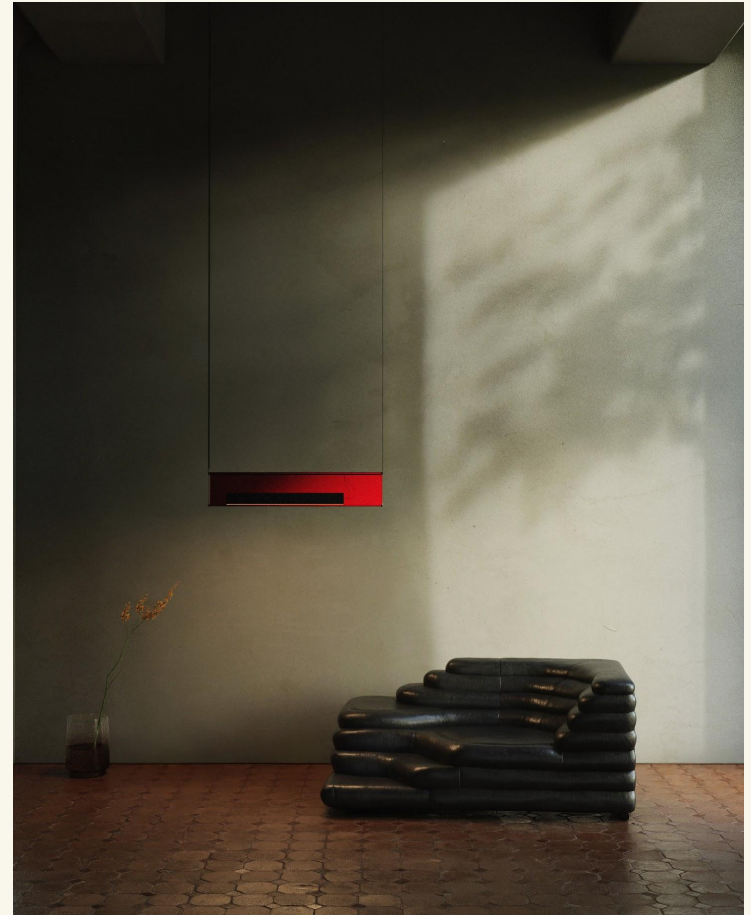

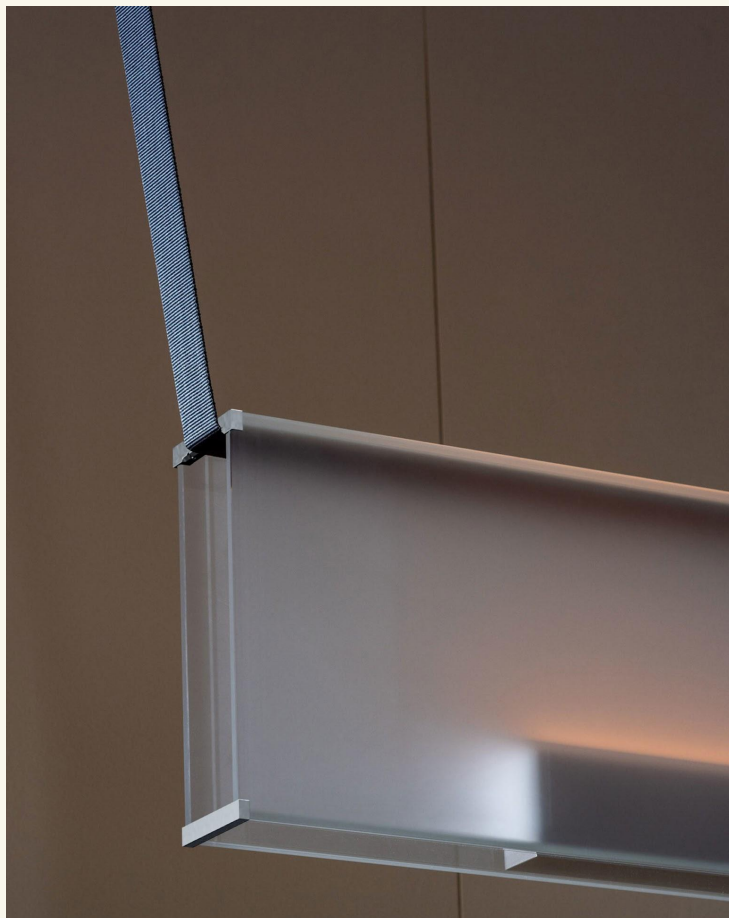



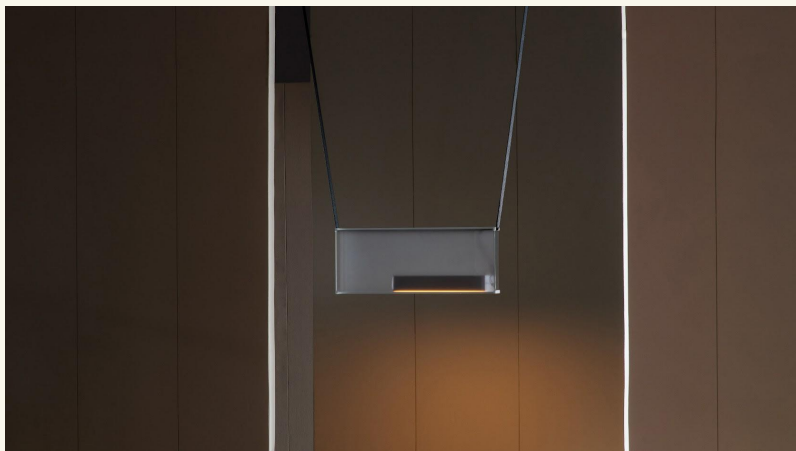

Within, an aluminum light box appears to float inside the color casting light upward or downward to suit the mood of a space. A quiet visual intrigue suspended in matter.

The whole is held together with intention: a flat nylon ribbon, everyday materials in quiet conversation with a graceful, minimalist form.

The form can be suspended from any angle and height, and in multiples, offering infinite architectures and possibilities.





The models and finishes

## The models

Sainte comes in four distinct proportions: square, portrait, landscape and large horizontal format.



Sainte 32



Sainte 33

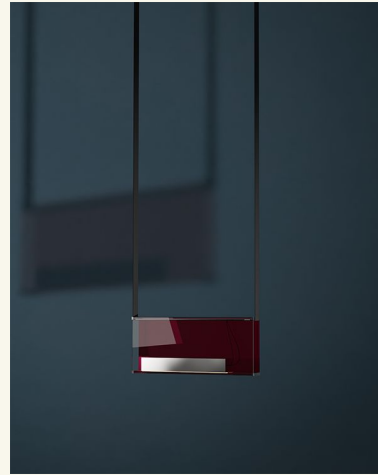

Sainte 35



Sainte 36

# Material Library

The six acrylic colors, all mass-tinted, are organized into three registers: deep, vivid and pure.

## Deep



DB  
Dark Bronze

SK  
Smoky Green

VR  
Vivid Ruby

RO  
Rose

FC  
Frosted Clear

EC  
Extra Clear



# Ribbon

Each silhouette is suspended by a 2-inch black textile ribbon, common to all models and can be installed on an angle or parallel vertical lines.





Technical specifications

# Dimensions

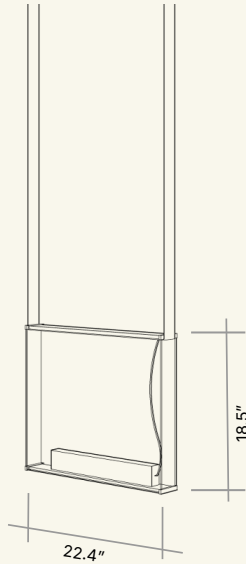

22.4" x 18.5" x 3"  
57 cm x 47 cm x 7.5 cm

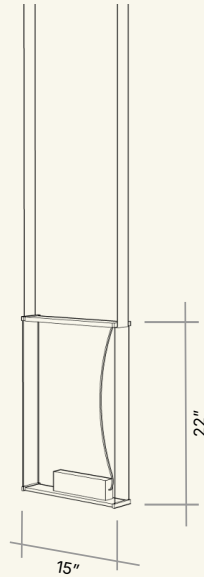

15" x 22" x 3"  
38 cm x 56 cm x 7.5 cm

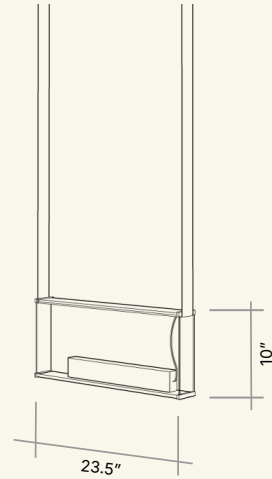

23.5" x 10" x 3"  
60 cm x 25 cm x 7.5 cm

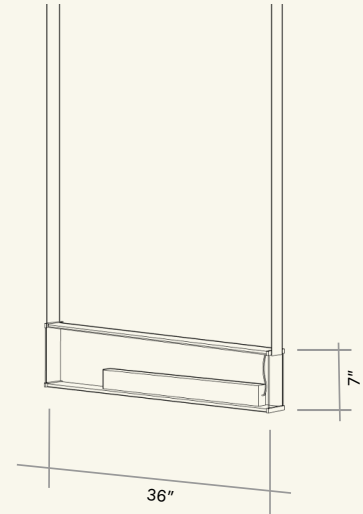

36" x 7" x 3"  
91.5 cm x 18 cm x 7.5 cm

Thank you.